

59' Deluxe Houseboat



LAKE
MEAD • MOHAVE
ADVENTURESSM



THE 59' DELUXE IS AN INEXPENSIVE AND EFFICIENT WAY TO TAKE AN UPGRADED HOUSEBOAT VACATION. THIS GREAT BOAT HAS A 14' BEAM AND IS LIGHTER THAN THE LARGER, HIGH-END MODELS; IT'S PERFECT FOR EXPLORING THE LAKE. PLUS, THIS BOAT IS ONLY HALF THE COST OF OUR PRICIEST MODEL. LOOKING FOR SOMETHING JUST A LITTLE NICER? CHECK OUT THE 60' EAGLE FOR EXTRA ROOM AND ADDITIONAL AMENITIES.

Length: 59 feet

Width: 14 feet

Capacity: The maximum capacity while underway is 12 persons

Staterooms: 4 Staterooms

Bed Details: 4 Queen Beds

Bathrooms: 1 Full and 1 Half Bathroom

Trip Length: 3 Day (2 Night)

Minimum Trip Length Marinas

Marinas: Lake Mead - Callville Bay, Lake Mohave - Cottonwood Cove, Lake Oroville, Lake Powell - Antelope Point, Trinity Lake

Special Features:

- TV
- DVD
- Stereo / CD Player / MP3
- Sun Deck
- Sun Canopy
- Deck Furniture
- Upper Deck Helm
- Upper Deck Wet Bar
- Upper Deck Mini Fridge
- Ice Chest

• Slide

• Swim Platform

• Bath Towels

• Bedding

Kitchen Features:

- Cookware
- Plates, Utensils, Glassware
- Coffee Maker
- Blender
- Toaster
- Refrigerator
- Microwave
- Stove
- Oven
- Outdoor Gas Grill

Specifications:

- 8 - 12 mph
- Twin Outboard Engines

Mechanical Features:

- Generator
- Power Outlets (110v)
- Water Heater
- Air Conditioning
- Furnace / Heater
- Marine Radio

Accessibility Features:

- Wide patio door with ramps
- Deck level side gate
- Wide Doors
- Grab Bars - Shower and Toilet

Onboard Supplies:

- Dishes & Utensils
- Dish Towels & Pot Holders
- Dish Drainer with Mat & Scrub Sponge
- Tableware Tray & Paper Towel Holder
- Indoor/Outdoor Trash bags included
- 1 Drawer Organizers & 2 Sink Plugs
- Ice Pick, Corkscrew & Can Opener
- 2 Non-Stick Spatulas & 2 Rubber Spatulas
- Soup Ladle, Large Spoon & Slotted Cooking Spoon
- Measuring Cup & Spoon Set
- Tea Kettle & Cutting Board
- Cheese Grater, Colander & Vegetable Peeler
- 4 Marshmallow Forks
- Paring Knife, Knife/Fork Set & Knife Sharpener

- Dinner Knives & Steak Knives
- Mixing Bowl Set & Baking Dish
- Cookware Set, Serving Platter & Pitcher
- Skillet, Griddle & Microwave Cookware
- Forks, Tea Spoons, Table Spoons & Salad Tongs
- Dinner Plates, Glasses & Cups
- 10 Sheets; 18 Pillows w/Cases; 5 Blankets
- 10 Bath Towels; 10 Washcloths
- Dust Pan with Broom, Bucket, Mop & Step Stool
- Vacuum with Attachments & 1 Fly Swatter
- Kitchen Dish Soap
- 2 Bathroom Wastebaskets & 2 Bathroom Soap Dishes
- Toilet Brush with Holder & Bio-Degradable Toilet Paper
- 2 Ash Trays
- Sledge Hammer, 8 Stakes & 4 Mooring Ropes

59' Deluxe Houseboat

- Personal Flotation Devices (12) & Two (2) Class 4 Ring Buoys
- Carbon Monoxide Detector, Smoke Alarms & Fire Extinguishers (3)
- Area Map & Operations Manual
- First Aid Kit & Marine Radio (VHF)
- Safety Railings, Ships Bell and SOS Flag

Capacities:

- 265 Gallon fuel tank
- 300 Gallon Potable water tank
- 300 Gallon waste tank

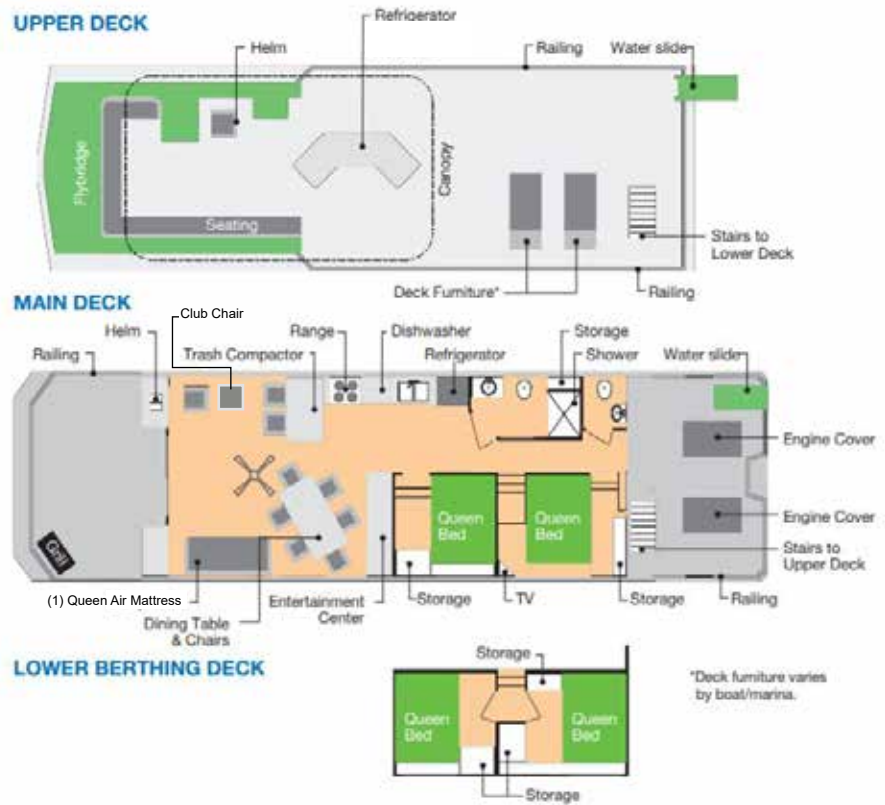

COTTONWOOD COVE MARINA

Season	Nightly	2 Nights	3 Nights	4 Nights	5 Nights	6 Nights
Off Season (1/1/24 - 5/19/24 or 8/31/24- 12/31/24)	\$1,331	\$1,941	\$2,912	\$3,623	\$4,206	\$4,658
Peak Season (5/20/24 - 9/1/24)	\$1,294	\$2,588	\$3,882	\$5,176	\$6,470	\$7,764

CALLVILLE BAY MARINA

Season	Nightly	2 Nights	3 Nights	4 Nights	5 Nights	6 Nights
Off Season (1/1/24 - 5/19/24 or 8/31/24- 12/31/24)	\$1,331	\$1,941	\$2,912	\$3,623	\$4,206	\$4,658
Peak Season (5/20/24 - 9/1/24)	\$1,294	\$2,588	\$3,882	\$5,176	\$6,470	\$7,764